

HILEY[®]

SHEER RIDING
PLEASURE

HILEY[®]

**TIGER SUPRA , TIGER KING RS
USER'S MANUAL**





BEFORE READING MANUAL

This manual contains important information to help you use your product more safely. For safe use, it is marked as 'Danger', 'Caution' and 'Warning' depending on the degree of danger and the meaning is as below.

Danger

Indicates a hazardous situation that could be a cause of serious injury.

Warning

Indicates a potentially hazardous situation that could be a cause in light injury.

Caution

Indicates a potentially hazardous situation that could be a cause in serious injury.

CONTENTS

Safety guidelines and restrictions	01
Precaution before driving	03
Name of each part	04
How to use the product	06
Display/Switch introduction	08
RGB lights Introduction	09
How to use the charger correctly	11
Safety precautions for lithium battery	13
Safety guidelines before driving	15
Maintenance	17
Product specifications	18
Guarantee card	19

Safety guidelines and restrictions



Be careful of water!

It is not recommended to use this product in rainy conditions, and it is strictly forbidden to submerge the product in water. If the product is exposed to water, it should be immediately dried in a well-ventilated and dry environment to avoid shortening the product's lifespan or increasing the risk of after-sales issues.

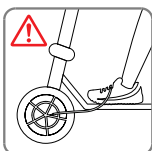

Beware of folding and spinning parts!

If parts of the body, as a finger or hair, get caught in the spinning or folding parts of the product, this may lead to severe injuries. Please be careful



No stunts

Stunts such as jumping and dropping are prohibited as they can cause a great impact on the product and can cause malfunction and accidents.



No companion boarding

This product is designed for one adult only, so children, infants, or two people are prohibited from boarding.



Don't tune by yourself

Do not open or turn the electric parts (battery, controller or motor system).

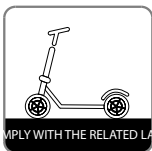

Comply with the related laws

Unlicensed, drunk driving, loading cargo on the scooter are prohibited. Please comply with the Road Traffic Act and related laws and regulations according to the place of use.

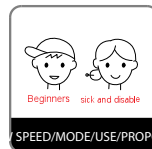

Beginners are encouraged to use at low speed

Beginners who are not accustomed to use the product, should avoid high speed mode driving and recommend low speed driving. In addition, please use after practicing how to ride safely in a wide & safe place.

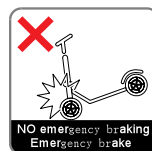

Do not suddenly brake with front brake

If there is a risk of overturning, sudden deceleration should be done safely. Do not apply any unusual behaviors or artificial forces, such as stopping with your feet.

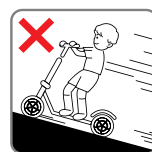

Do not accelerate downhill

Slow down at downhill. When reducing the speed, use the brakes properly to reduce the heat on the disk.

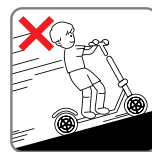

Do not drive on steep slope

Acceptable gradeability is different for each product. Excessive hill roads exceeding the specification may cause damage to the product (parts) due to temperature cut, over current or low voltage cut, which may cause the product to malfunction.



Safety warning when lifting the product

Don't not lift the product by holding ONLY the stem. Be sure to hold the front part of the product's body with one hand, and hold the handle on footrest with another hand. Be careful that do not hurt your back or knees.



Be sure to wear safety equipment

For the safety of passengers, be sure to wear a full face helmet and the other protective gear (knees, elbows, hand, upper body) and do not wear shoes such as slippers, high heels that interfere with driving.

Precaution before driving

- 1 Night driving should be avoided at all times. Always wear helmets and other guards (knees, elbows, hands, upper body, etc.) and drive safely.
- 2 Select the mode that suits you and drive. In order to cope with the sudden situation, be prepared to slow down by holding the brake at all times.
- 3 When turning left / right, turn on the signal lights in advance and slow down to avoid danger of overturning or slipping, then turn slowly and safely.
- 4 To go backwards safely, get off the product only after coming to a complete stop.
- 5 It is prohibited to use in any places that are slippery, crowded, have a steep slope, or are uneven.
- 6 When crossing a pedestrian crossing, get off the product for pedestrian safety.
- 7 Do not drive in a way that threatens any other means of transport, such as animals, pedestrians, bicycles, motorcycles, cars, etc.
- 8 When passing speed bumps and road obstacles, be sure to slow down.
- 9 When decelerating or braking, do not stop with your feet, but by using the brake appropriately.
- 10 Be careful that there is a risk of burns due to heat from the motor and brake (especially disk rotor) after driving.
- 11 It is prohibited to drive by holding the handle with one hand; please use both hands at all times.
- 12 Do not ride or drive when the kick stand is down.
- 13 For safe braking, check whether the brake lever and drum brake connection are damaged before and after driving (wire damage, external breakage, etc.). And check brake wear and looseness of brake inner core (inner wire). In the case of hydraulic brakes it is also necessary to check the oil leakage or deficiency and always check that the braking force is sufficient. Due to various factors such as road surface condition and speed, the brake can't stop the scooter as expected. The electric ABS function is an auxiliary function to further increase the braking force. The user should understand the electric ABS and consider the braking time when riding.

Name of each part

Tiger Supra:



- 1 Handle Bar
- 2 Front Signal Lights
- 3 Head Lamp with Horn
- 4 Stem
- 5 Folding Lock
- 6 Front Suspension
- 7 Front Fender
- 8 Front Motor/Wheel with Disc

- 9 Kick Stand
- 10 Foot board with Non-slip Pad
- 11 RGB Lights
- 12 Rear Foot Rest
- 13 Rear Motor with Disc
- 14 Rear Fender with Reflector
- 15 Tail Light / Rear Signal Light
- 16 Rear Suspension

Name of each part

Tiger King RS:



- | | |
|--------------------------------|----------------------------------|
| ① Handle Bar | ⑬ Rear Motor with Disc |
| ② Front Signal Lights | ⑭ Rear Fender |
| ③ Head Lamp with Horn | ⑮ Tail Light / Rear Signal Light |
| ④ Stem | ⑯ Rear Suspension |
| ⑤ Folding Lock | ⑰ Multi-function button |
| ⑥ Front Suspension | ⑱ Display |
| ⑦ Front Fender | ⑲ NFC |
| ⑧ Front Motor/Wheel with Disc | ⑳ Throttle |
| ⑨ Kick Stand | ㉑ Brake Levers |
| ⑩ Foot board with Non-slip Pad | ㉒ Handle Grip |
| ⑪ RGB Lights | ㉓ Hook |
| ⑫ Rear Foot Rest | |

How to use the product



• Product Unfolding



STEP 1

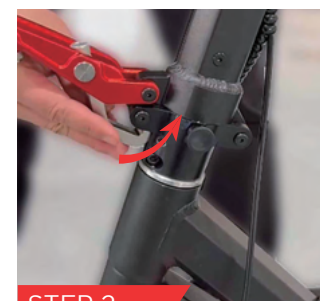

STEP 2

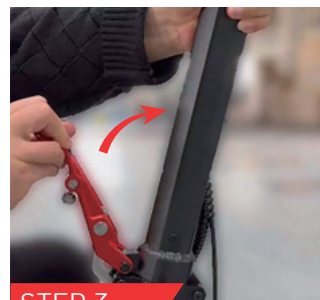

STEP 3



STEP 4

How to use the product

• Product Folding



• Lock Handlebar

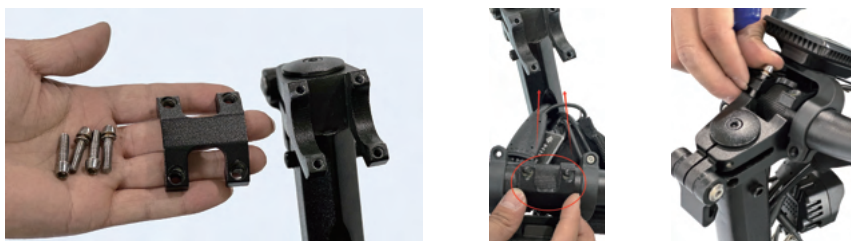

Display/Switch introduction

• How to Start the Scooter

- 1 Press and hold POWER button for 2-3 seconds until light up the power-on interface.
- 2 There are two ways to power on the scooter: ①Put NFC on the sensing area of the display screen.②Put password (you can set by yourself)
- 3 Engage the Throttle lightly for start.

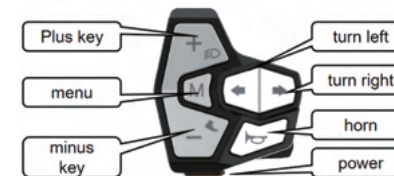

NOTES:

- *If your scooter under "Kick Start" mode, you need kick the scooter when you engage the throttle.
- * NFC sensing area on UKS6 display.



• How to Power Off the Scooter

- Two ways to power off the scooter: ①Press and hold POWER button for 2-3 seconds. ②Put NFC on screen until it turned off.

• Display Introduction

Please check the user manual of display to learn more details.

RGB lights Introduction

The RGB lights are installed on both sides of the bottom of the scooter's foot board.



1. How to Turn on the RGB Lights.

Press and hold the "+" button, both the RGB light and tail light will turn on at same time.

2. How to Download the RGB App

Step1: Scan the QR code and download the App

( duoCo Strip).

Step2 : Start App, search and connect the Bluetooth controller (make sure the Bluetooth on your mobile phone is open).

Step3: Set light color via the App.



RGB lights Introduction



NOTES:

- Enter the "Guide" menu to find more operating instructions.
- LED Bluetooth controller is directly controlled via the mobile phone and the distance can reach 20m, no need to set up, easy to connect open the software within 5 seconds you can automatically connect the controller.
- Colorful gradient .
- All kinds of monochrome, color gradient .
- All kinds of monochrome, to see colorful flashing of the lights
- Colorful jump .
- The rhythm of the music changes .

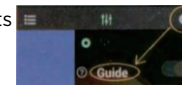

How to use the charger correctly



Basic charging method

- 1 Open the charger port cap and connect it to the connector of the charger and connect it to the household outlet.
- 2 Charging status indicator: (Red) Charging;(Green) Charging complete.
- 3 Be sure to close the charger port cap when driving or storing except when charging.
- 4 When connecting the connector to the charger port, there may be metallic sparks due to voltage difference, but this is normal.

*Some of the models are designed with two charger ports, you can use two chargers at same time, *but total current MUST under the limited current, which is announced by manufacturer.*

⚠ WARNING !

Failure of the charger and abnormal conditions can cause electric shock and fire. Learn the correct usage and prevent safety accidents in advance.

- 1 Manufacturers and sellers are not responsible for any problems arising from any disassembly, modification, or mixing with other chargers.
- 2 The charger is forbidden to be used in places subject to high humidity, heat, flammable materials, confined spaces, or where there is no ventilation such as in a car.

How to use the charger correctly

- 3 The charger is not waterproof. It is thoroughly controlled to prevent moisture from entering the charger.
- 4 Children and pets should not be allowed to approach the charger when they come into contact with them, as they may cause an electric shock.
- 5 If charger lamp does not light, charger fall down, strong external shock, long time charge, or cable cover damage, discontinue use immediately and contact the service center.
- 6 Unplug the charger when you are away from home for long periods.
- 7 Use only genuine charger.
- 8 Do not insert conductors into the charging port.
- 9 Do not touch the plug for about 10 seconds after unplugging the charger. There is a risk of electric shock from instantaneous discharge.
- 10 Do not remove the terminal during charging. Otherwise you may charge the internal circuit of the charger and cause malfunction.
- 11 Do not operate the product during charging.
- 12 Charging terminals should be firmly contacted during charging and should not be used if terminals are corroded or damaged.
- 13 When disconnecting the charger from the product, it is safe to hold the terminal without holding the wire.
- 14 Disconnected the charger from the product after charging complete, otherwise there is a risk of overcharging.

Safety precautions for lithium battery

- 1 **Care** Lithium batteries should be protected from direct exposure to children and pets.
- 2 **Performance**
 - ① Lithium battery is affected by external temperature. In winter, when the temperature is low, the performance of the battery is temporarily deteriorated and the mileage and power output is reduced.
 - ② Lithium battery has a characteristic that discharge performance is reduced by more than 15% when charging /discharging 300 times or more. If usage time is shortened due to long usage, it should be replaced with a genuine one through the service center.
- 3 **Charging**
 - ① Lithium battery should be used only with genuine battery and charger supplied by the manufacturer. Any problems caused by use of battery not made by the manufacturer ,mixed use,or using the charger are not covered by the manufacturer.
 - ② Charging the lithium battery with a non-genuine charger may caus malfunction or fire.
 - ③ The lithium battery should be charged in a well-ventilated, dry place and around the charger in a place where there is no inflammable material.
 - ④ Lithium battery should be charged at 0-45℃ and discharged within -10-60℃. Charging or discharging at a temperature outside this range may cause malfunction, fire or explosion.
 - ⑤ In case of moving from cold outside to warm indoor,please charge it after 1-2hours. This is to prevent condensation from occurring inside the product due to temperature difference.
- 4 **Storage**
 - ① Lithium batteries should be kept away from snow, rain and direct sunlight. Do not store or charge them in a trunk or hot room. Select a dry place and store at room temperature (10 - 20 ℃).
 - ② When storing for more than 3 months, *charge the remaining battery level to 70 - 80% (do not store full charge).*

Safety precautions for lithium battery

- 5 **Trouble symptom, safety**
 - ① Lithium battery should be discontinued immediately if it is damaged or leakage of battery, sour odor, appearance deformation, etc.Please contact the place of purchase to get technical support and service.
 - ② If overheat,smoke or ignition is detected in a product with lithium battery, immediately stop charging or use, move the product outdoors as soon as possible, and then use a fire extinguisher to extinguish flames. Do not spray water or immerse the product in any situation ,which can lead to more danger.
 - ③ Lithium battery pack has very high energy density, so if you charge the battery for a long time and there is a case of short-circuit, leakage, bad battery, etc., it can lead to ignition.Therefore, you should avoid charging for a long time without a person being present to avoid the risk of unexpected fire.
- 6 **Misuse** If the lithium battery is short-circuited or the polarity is changed, or if the battery is impacted, malfunction or fire may occur.

If you think that the battery has been impacted, you should stop charging and using it and visit the nearest service center for inspection.
- 7 **Water inflow** It should be controlled to prevent water inflow into the lithium battery. There is a risk of fire or electric shock if the charger is connected while moisture is present.
- 8 **Caution** Disconnect the battery from the main unit except when recharging and reinstalling.Do not use for any purpose.
- 9 **Disposal** When disposing of the lithium battery, the battery should be separated from the product at the point of purchase or near the service center and the charge and discharge terminals are not short-circuited. Dispose of it as industrial waste.

DANGER !

**Battery disassembly prohibited:
Battery disassembly,modification and repair are not covered under warranty.**



Safety guidelines before driving

Required checking before use

Step1: Check throttle and handle

- * Operate the accelerator throttle lever about 2 - 3 times to check whether it returns to the home position.
- * Be careful that excessive throttle leaning and manipulation of the throttle can cause malfunction due to internal parts damage.
- * Check the free gap in the handlebars before using.

Step2: Check brake and cable

- * The brake braking force is sufficient to check the operating condition. If the braking force is significantly lowered, use it immediately after inspection and action.
- * Check that the brake pad is not worn, that the cable is not loose, that the cable is not damaged, and that there is no leakage in the case of hydraulic brakes.
- * If there is an unusual feeling or noise during operation, check for breakage, wear and deformation of the inner wire of the brake cable.
- * Check that the bolts and nuts of the brake fixing parts are not loose and that the disc is not deformed or damaged.

Step3: Check tire pressure and abnormal tread wear

- * Check the front and rear tires for wear and punctures and check the value marked on the surface of the tire. *The air pressure should stay at 48 to 50 psi.* When the air pressure is shortened, the possibility of puncture increases, so check always.
- * It is necessary to judge the replacement time by observing the appearance of the tire such as tire damage, uneven wear.

Step4: Tightening check such as folding part and handle part

- * Make sure that the bolts and nuts of all parts of the product are tight and free from loosening. Check the fastening condition and clearance of the folding and fixing parts of the handle (folding knob, swing arm, folding related parts, suspension arm bolt, swing arm bolt, etc.)

Safety guidelines before driving

DANGER !



In these cases, stop driving immediately.

If you encounter any of the following situations while driving, stop driving immediately and contact your nearest branch or service center for proper measures.

If you provide pictures and videos to get accurate diagnosis, professional counseling is available.

- * Unusual heating of the motor
- * Brake braking status error
- * Error messages on the instrument panel
- * When the throttle is returned to its original position
- * Abnormal noise if generated
- * Product smoke, ignition, sour odor
- * When rain or wet with water or in a similar situation
- * When other driving is judged to be unreasonable.
- * When battery doesn't fully charge and shorter riding distance after a full charge (Battery explosion may be caused due to faulty battery cell or battery cell breakdown)

Maintenance

Maintenance and self-maintenance

Electric products can be damaged by various factors. The life span of each part varies depending on driving habits and driving environment. Parts that exceed the service life may cause accidents. Let's manage various parts and prevent safety accidents in advance.

Step1:Check the replacement timing of consumable parts

① The components and suspension, tires, tubes, wheels, bearings, discs, brake pads, cables and folding parts, various brackets and other consumable parts require periodic inspection and must always be checked.

Step2:External damage inspection by driving environment.

① Replace parts that may be damaged by external driving environment, such as deformation of parts or tiny cracks due to pressure.

② If the product is exposed to strong sunlight for a long time, discoloration may occur.

③ In case of jumps, heavy impacts such as turning, collision, etc., when driving frequently or for a long time in a poor road condition or driving for thousands of kilometers or more, fatigue breakdown phenomena may happen. So please check the parts replacement schedule for each product and replace accordingly for safely.

④ Fatigue breakdown and maintenance parts may differ from the example conditions depending on the driving environment and the operating conditions. Also check parts other than the replacement cycle (maintenance parts) at all times to check for any signs of abnormality.

IMPORTANT NOTICE !

① Please note that after running, there is a risk of burns due to the heat on the motor and brake (especially disk rotor) side.

② Be careful that the bolts of the motor, rim and motor shaft may become loosened due to the ABS function.

③ Folding parts and joints where movement occurs due to product characteristics can naturally damage the surface or paint surface during use, especially when operating in incorrect operation and form.

④ As you continue to use the brakes, the brake pads become worn out and the gap between the pad and the rim becomes wider. When the braking power drops, please ask the service center change brake pad or adjust the brake device for you.

⑤ After using the scooter in rainy days, *please place the scooter in a ventilated place (not in living rooms) to dry before next use.*

Product specifications

Picture				
Product Name	Tiger Supra	Tiger Supra pro	Tiger Supra VLR	Tiger King RS
Battery Capacity	60V 31.5Ah/1890Wh	60V 35Ah/2100Wh (SAMSUNG)	60V 40Ah/2400Wh (SAMSUNG)	72V 35Ah/2520Wh (SAMSUNG)
Max Speed (km/h)	Around 20km/h	Around 20km/h	Around 20km/h	Around 20km/h
Range (around km)	105km	120km	135km	135km
Tyre Size (inch)	90/55-6.5 city (Tubeless)	90/55-6.5 city (Tubeless)	90/55-6.5 city (Tubeless)	100/55-6.5 CST city/off road (Self-Sealing tire, tubeless)
Braking System	F&R NUTT OIL brake+Electric brake (4Piston Heat Dissipation Pads)			
Suspension	F&R HYDRAULIC suspension (adjustable by Knob)			
Light System	Headlamp with horn+Signal light +Side RGB on deck (control light color by APP)+Tail light			
Dashboard	UKS6	UKS6	UKS6	UKS6
Charging Time	9h	10h	11h30m	11h40m
Waterproof (IPXX)	IPX6	IPX6	IPX6	IPX6
Color	Dark black	Dark black	Dark black	Sunlight gold
N.W.(kgs)				

NOTES:

* The specification/design can be changed by manufacturer without notice to improve the quality.

* The distance can be affected by loaded weight, wind, road condition, and tire condition.

* After long time use, the waterproof components on scooter (such as rubber and plastic parts) will age, resulting in diminished waterproof performance

Guarantee card

User information:

Name: _____

Tel/Mobile phone: _____

Email: _____

Address: _____

Product information:

Order NO.: _____

Model number: _____

Series number(laser on body frame): _____

Date of purchase: _____

Date of return: _____

Fault description: _____

Fault cause: _____

Signature of receiver:

Guarantee card

User information:

Name: _____

Tel/Mobile phone: _____

Email: _____

Address: _____

Product information:

Order NO.: _____

Model number: _____

Series number(laser on body frame): _____

Date of purchase: _____

Date of return: _____

Fault description: _____

Fault cause: _____

Signature of receiver:
